



Studio C, 114 Fisherton Street, Salisbury, Wiltshire, SP2 7QY

£795 PCM

A part furnished one bedroom second and third floor flat, situated in the city centre, just a short walk from the train station.

Entrance into open plan kitchen/living space with dual aspect, electric oven and hob, washing machine and fridge. Shower room.  
Stairs to large double bedroom with eaves cupboard. Electric heating. Single occupancy. No pets. No parking.

## Ground Floor

Approx. 26.9 sq. metres (289.6 sq. feet)

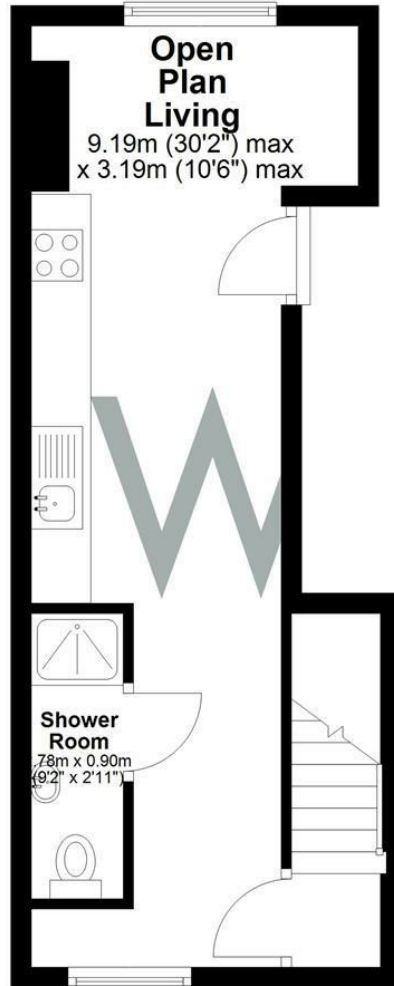

Total area: approx. 46.3 sq. metres (498.8 sq. feet)

## First Floor

Approx. 19.4 sq. metres (209.2 sq. feet)

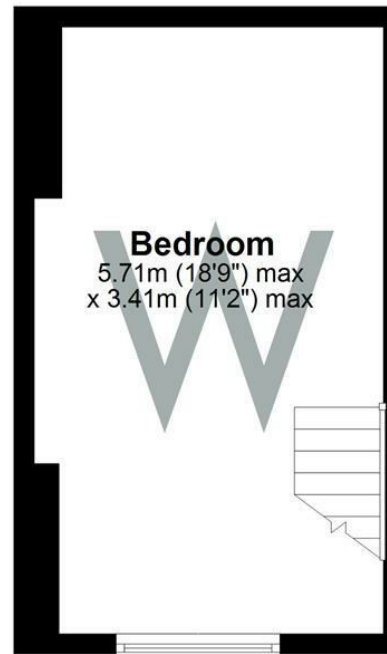

Energy Efficiency Rating		Current	Potential
Very energy efficient - lower running costs			
(92 plus) <b>A</b>			
(81-91) <b>B</b>			
(69-80) <b>C</b>		<b>69</b>	<b>69</b>
(55-68) <b>D</b>			
(39-54) <b>E</b>			
(21-38) <b>F</b>			
(1-20) <b>G</b>			
Not energy efficient - higher running costs			
England & Wales		EU Directive 2002/91/EC	

**WHITES**  
Castle Chambers, 47 Castle Street,  
Salisbury, Wiltshire, SP1 3SP  
01722 336422  
www.hwwhite.co.uk  
residential-sales@hwwhite.co.uk

